

I am very glad that you are reading this article. Today, the world is full of many information, in which it is often difficult to find the sense. First I would like to say a few words about myself. My life activities are connected with the Moravian region. By the way, just to clarify, this is the second part of the Czech Republic, east of Prague. My interest has always been based on the creation of various objects, like drawing, ceramics clay modeling and many other artworks. This led my way naturally to architecture and graphic design. If you are designing the architecture is an important part of process to solve quality of graphical presentations. That is why I came to learn graphics programs and started to organize and teach at graphic art workshops. I realized that it would be a pity to not to pass this awareness further.

My professional career is based on two fields, architecture and pedagogy studies. I studied at the Faculty of Architecture in Brno and the Faculty of Education also in Brno, the field Fine and Visual creation. My focus is based of these two different fields which seems not be so connected. But in fact, these approaches have many same aspects and are in the beneficial symbiosis. The optimal combination of these two worlds – the world of architecture and graphics areas and education, brings new challenges and areas for self reflection.

Then the question is: How can be the world of architecture and art connected with ecology? Architecture creates the world around us, it is everything that surrounds us and deformed us. For the architect as the creator there is important question: How to use properly spaces? Especially how to take ideological and moral responsibility of public spaces.

Most environmental problems are linked with the absence of planning or bad quality of planning. There are the small-scale construction, large countrysides and the big landscapes. For example, the result of bad composed urbanism leads to the traffic jams, to long driving distances, to a bad water distribution in nature and many other problems. About



Picture 1.- Schwartzplan of area (blue)

many of these problems nobody would tell that they are associated with architecture.

Ecological view is very important aspect in the designing of development architecture. And how the creative artistic activities fits into this topic? We can see connections between artistic quality and ecology. Environment with great artistic and visual value are more sustainable and has many ecological added values. I can tell that my first contact with the problems of ecology came naturally from a complex and balanced interaction between science and art. So, that is architecture.



Picture 2.- Area of public space for designing

Now, finally I present you the project. That is currently at the level of vision and conceptual studies. Project joins the recreational usage with zones for accumulation of water and all this is connected with the elements of small architecture and land art. The main goal is to improve conditions for the use of principles of green and landscape architecture.

Designed space is located in the city part called Olomouc – Hodolany. As can be seen on the first picture, the place is located in the eastern part, at the east of the main railway line. Railways were the element of development especially in the period of Austria – Hungary monarchy, but today there is also a source of future barriers. We can see consequences of different development till today.

Strong industrial tradition and genius loci became the impulse for my creation of the architectural designs just on this area. Another factor is the absence of the other fine art or cultural institutions in the east part of Olomouc. In Picture number 1 there is marked in red points important arts institutions and blue one is the location of my proposal. As you can see, in the east, yet there is no major art or cultural institution.

Another impulse for choosing this location was excellent starting position of current garden as seen in

the photography documenting this stage. The space there creates an imaginary oasis in very industrialized, but not very well maintained, part of the city. Garden provides many artificial corners with big potential for the artistic realization in many various ways. Genius loci is the most respected and scenery contains only other smaller construction.

From an ecological perspective is the most important adjustment in this design of this space, where is now asphalt. The plan counts with the elimination of these paved asphalt surfaces and replacing with a clay. The aim is to reduce asphalt surfaces and replacing with an earth. This approach is little bit going against the strategy of municipality of city and against huge bureaucratic requirements by this policies. So I can tell

proverb which can characterize this: „The purpose justifies the means.“

So what is it the message? I think there are several, but one thing unites them. It is a phenomenon of citizen initiatives which is a needed to develop. At least the small activity each of us can raise whole complex to the higher level.

*The plan counts with the elimination of these paved asphalt surfaces and replacing with a clay.*

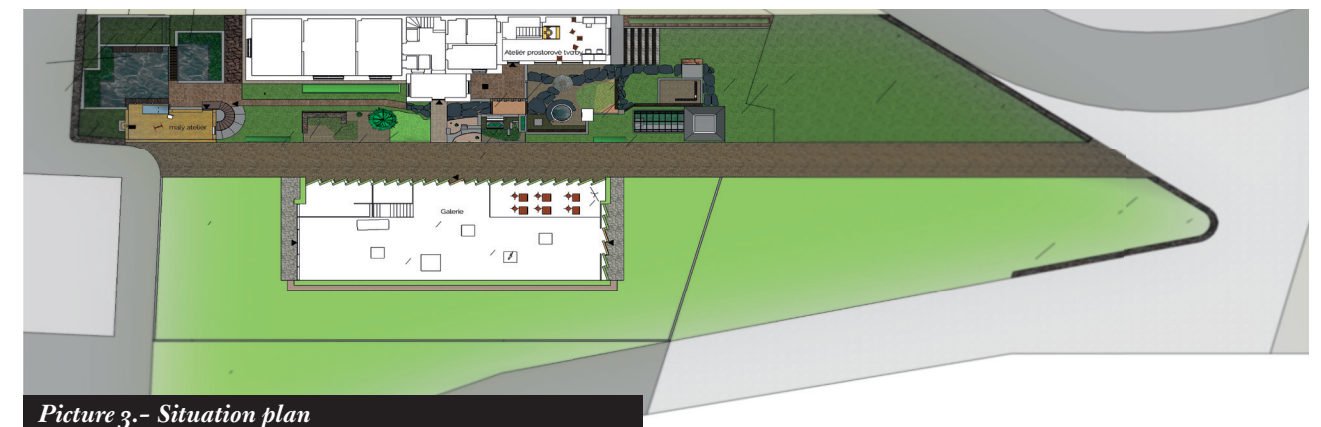

Picture 3.- Situation plan